



YOUR EXHIBITION IN FLORENCE
dossier

a partnership between:



La Macina di San Cresci

Pieve di San Cresci 1
50022 Greve in Chianti (FI)
+ 39 055 8544793
info@chianticom.com
www.chianticom.com



Galleria 360

Borgo Ognissanti 77/r
50123 Firenze
+ 39 055 239 9570
info@galleria360.it
www.galleria360.it



Partnership



La Macina di San Cresci and Galleria360 have established a strategic collaboration to offer an opportunity to the artists in residence.

La Macina di San Cresci has a consolidated history of residence for artists and organization of artistic and cultural projects for the enhancement of the territory. Its location in the heart of Chianti area and the splendid historic building, from the 10th century, form an exciting combination. Freedom to create!

Galleria360 is a contemporary art gallery situated in the historical center of Florence, a city of art as excellent as its glorious past. The gallery was born from a shared passion and enthusiasm of the arts from Angela Fagu, for whom Florence and Contemporary Art do not represent two antithetical extremes. Through the works of high-level international artists, they give rise to new dialogues between reflection and criticism, art and thought, and especially art and life. Galleria360 stands out as a reference point for the international avant-garde scene.

HOW EXHIBIT

It is possible to organize an exhibition to the Galleria360 in Florence subordinated to a residence at La Macina di San Cresci for a minimum of 3 weeks.

The artist who intends to exhibit in Florence together with the project she/he wants to develop during the residency have to present the project for the exhibition.

Acceptance for the exhibition will be made by the Directors of La Macina di San Cresci and Galleria360.

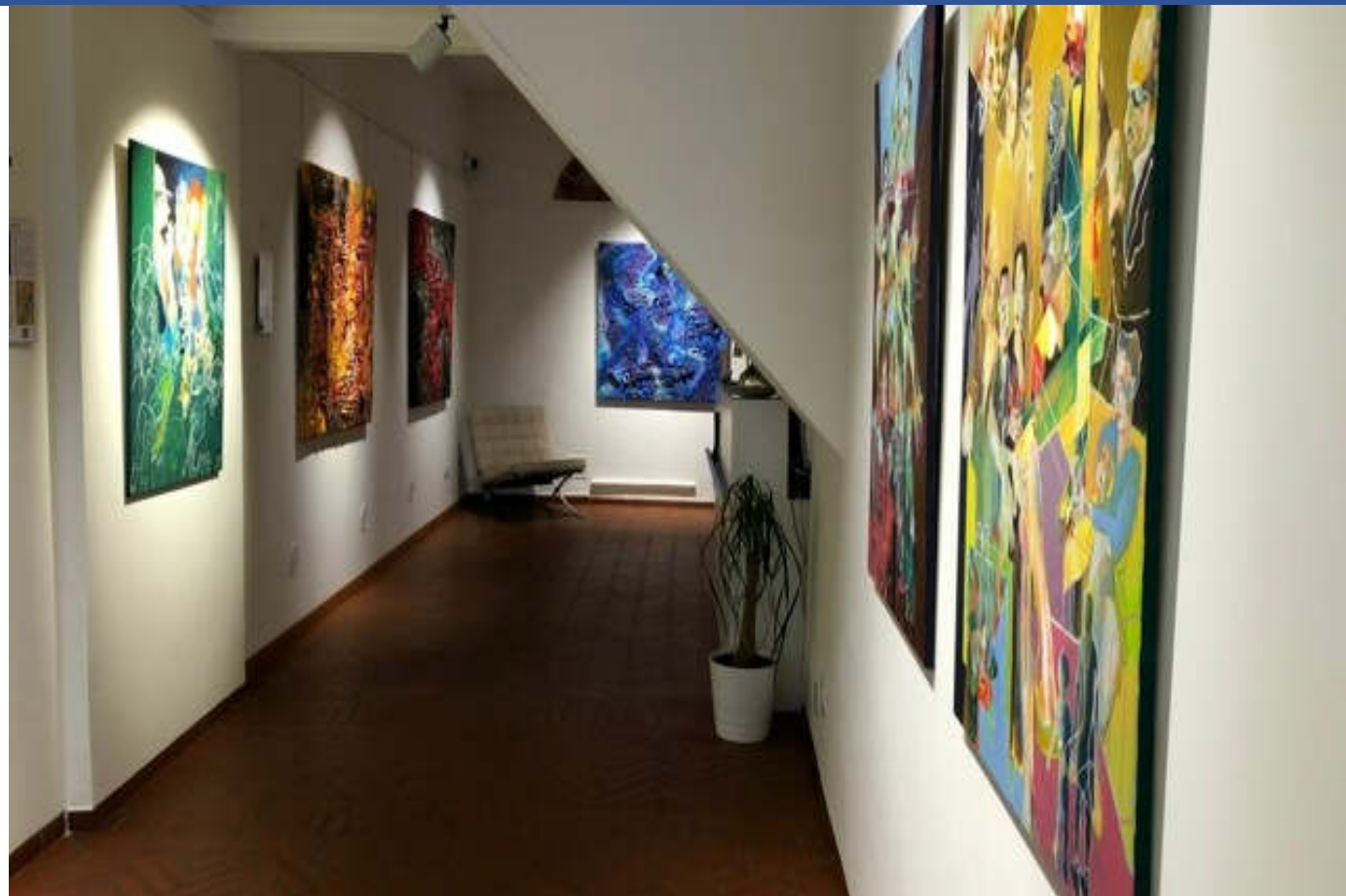



Exhibition (solo or group)

There is the possibility of exhibiting the works
group show
or
solo show

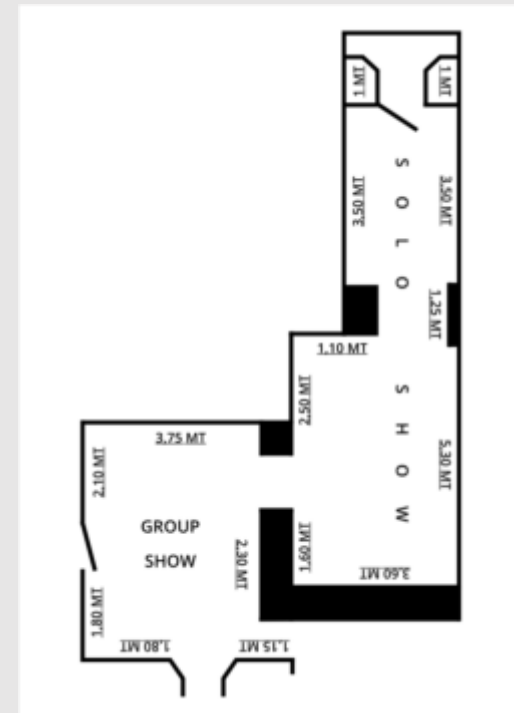



Services by the Gallery:

- ◆ Mounting and dismounting of the exhibition.
- ◆ Exhibition space dedicated to the artist's works.
- ◆ The design and the printing of the brochures.

Critical writing made by our art critic (for each artist) in two languages (English and Italian).

- ◆ Creation of the press release made by our art critic.
- ◆ The brochures will be delivered to the numerous hotels, residences, banks, professional studios, cultural spaces, public spaces.
- ◆ The announcing of the exhibition on art and culture websites.
- ◆ The realization of the exhibition website and dedicated press releases on: www.galleria360.it
- ◆ The advertising on the Social media (Facebook, Instagram).
- ◆ The press release will be sent by our art critic Virginia Bazzechi G.C. to the specialized magazines and daily newspapers.

- ◆ Some copies of the brochures will be given to the artist

Interview artist curated by our art critic. The interview can be done in 2 ways: written interview, the art critic sends the questions by email the answers to the questions sent by e-mail. Remote video interview and the remote video interview later it will be posted on Instagram.

- ◆ The opening of the exhibition It will be done live streaming on Instagram (if the situation of the covid-19 change it will be live jazz music, exhibitions opening event with drinks and food, presentation of the exhibition from Angela Fagu and Art Critic)

- ◆ Promotion of the works during the exhibition from the gallery staff.

- ◆ Presentation of the exhibition from the Art-Director of the gallery and Art Critic.

- ◆ Gallery Hours: Monday to Friday 10.00 am to 1.00 pm / 3.00 pm to 7.00 pm. Saturday and Sunday closed (the gallery reserves the faculty to change the opening hours). The gallery is in a strategic position, we are in the homonymous street Borgo Ognissanti and we are a stone's throw from one of the squares most important in Florence "Borgo Ognissanti" where there are 2 important hotels "Westin Excelsior" & "Saint Regis". And we are 5 minutes away from the "Duomo".



Exhibition costs

The exhibition is three weeks long.

The price (group show) including all the services listed above is € 1 600 (VAT of 22% included)

The percentage of the sale of each work by the artist will be of 80% and 20% for gallery.



Support by La Macina di San Cresci

- Technical and logistical assistance to the artist to better coordinate the exhibition
 - Frames available that can be used if the measurements are in accordance with the size of the works
- Advertising of the exhibition on social media and on the website of La Macina
- Mailing list invitations
- (services included)

Frames available at La Macina di San Cresci:

IKEA mod . RIBBA color BLACK

- N. 3 RIBBA CM 50X70 (19 inch x 27)
- N. 4 RIBBA CM 50X50 (19 inch x 19)
- N. 20 RIBBA CM 30X40 (11 inch x 15)



how your works in Florence

You can ship the works before the exhibition.



You can bring the works with you and arrive at the residence at least 10 days before the opening



For longer periods of residence, you can make the works at La Macina and then exhibit them





We wait you!